

ADAIR HOMES

the **POWELL**

1,833 SF | 3 Bed | 2 Bath



SPANISH



the POWELL

1,833 SF | 3 BED | 2 BATH

- Open Great Room
- Kitchen with Walk-in Pantry
- Large Utility Room with Extra Storage
- Covered Front Porch
- Spacious Entry

EXTERIOR ELEVATION OPTIONS



CRAFTSMAN

View all elevation options at www.AdairHomes.com

Elevations are artistic renderings and may include items not standard to the plan. Ask your Home Ownership Counselor for more details.

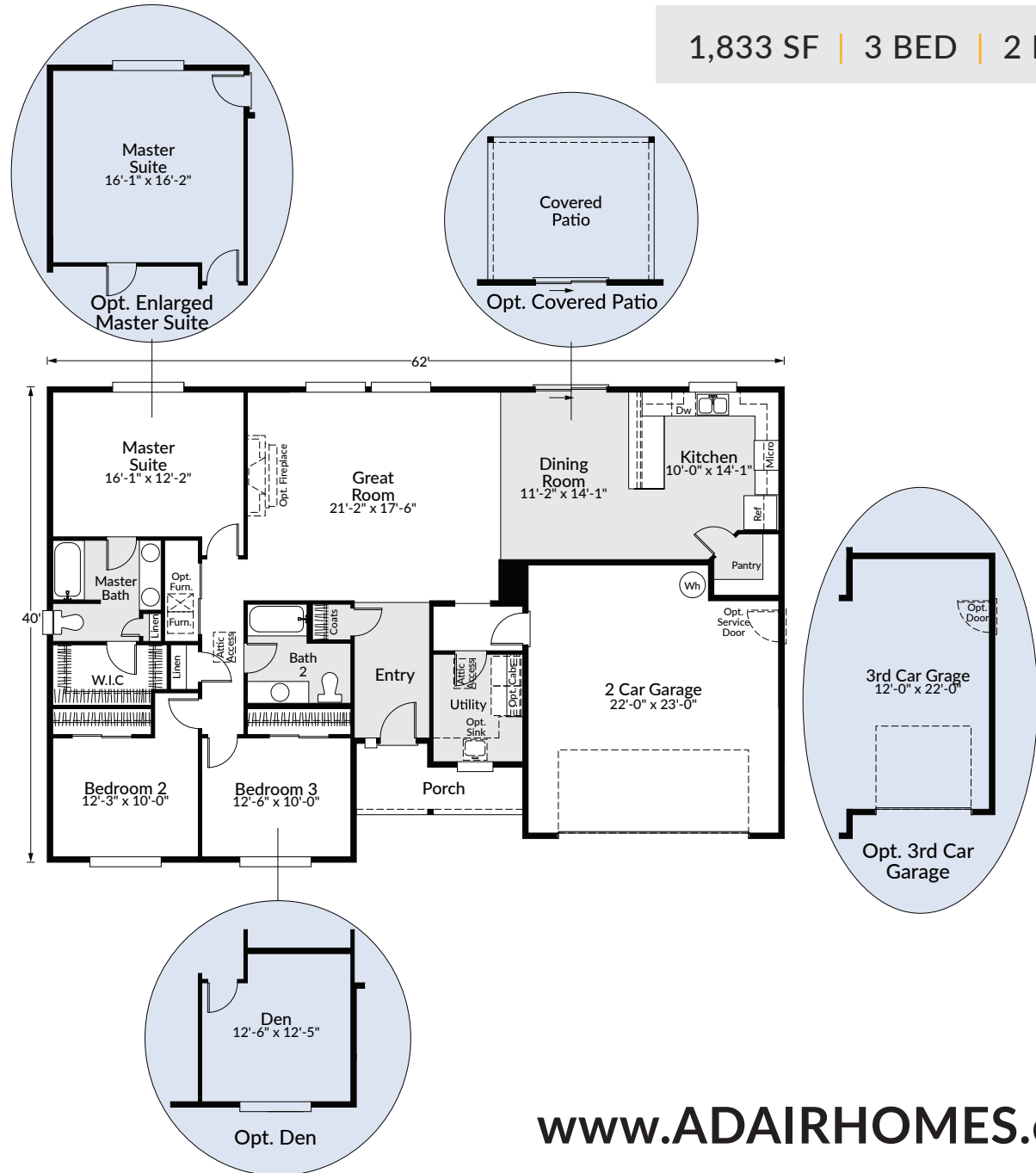

www.ADAIRHOMES.com

